



# Bharat Seva Sansthan

Moti Mahal, 2 Rana Pratap Marg, Lucknow – 226001  
Email : cbgbss2011@gmail.com | Tel No : 0522-2287336

## **PART – A**

Repairing/ Painting & Distempering of old Boundary Wall, Hospital Building, Training Centre, Hostel Building, Pump House & Garrage of Chandra Bhan Gupta Eye Hospital & Training Center Hathaudha Kotwa Sadak (Barabanki)

S.No.	Particulars	Quantity	Unit
1.	Providing and applying Birla Putty on new work and making surface smooth by sand paper and painting two coats of exterior paint of specified quality, the second coat be applied when first coat has dried up, including cost of material and labour and T&P etc. required for proper completion of the work.	1438.00	Sq.M.
2.	Providing and applying Birla Putty or cement sand mortar after scraping the old work as may be required to smooth the surface and by using sand paper and painting two coats of exterior paint of specified quality, the second coat be applied when first coat has dried up, including cost of material and labour and T&P etc. required for proper completion of work.	6361.00	Sq.M.
3.	Repairing iron and wood work with suitable putty after scraping as may be required to smooth the surface and by using sand paper and painting with one coat of their ready mixed primer paint of Berger quality and two coats of Berger paint of specified quality & colour, the second cost of material and labour and T&P etc. required for proper completion of work.	630.00	Sq.M.
4.	Misc. repairing work such as plaster/window glass fitting and repair of stair case etc.etc. wherever required including cost of material and labour and T&P etc. required for proper completion of work.	L.S.	L.S.

## **PART – B**

Construction of Boundary wall of Chandra Bhan Gupta Eye hospital & Training Centre  
Hathaudha Kotwa Sadak (Barabanki)

<b>S.No.</b>	<b>Particulars</b>	<b>Quantity</b>	<b>Unit</b>
1.	Earth Work in foundation upto the level as shown in the drawing and disposal of surplus earth as directed at site upto a lift of 1.5 M. and lead upto 50 M. and proper consolidation of foundation by filling water and ramming till foundation is properly done. Also filling back the earth in foundation as required, after brick work in foundation upto plinth level is completed.	23.00	Cu.M.
2.	Laying cement concrete 1:6:12 (1 cement, 6 fine sand and 12 brick aggregate of 40 m.m. size) in foundations and its ramming till it is properly consolidated by pouring water as required, including cost of material and labour and T&P etc. required for proper completion of work.	6.00	Cu.M.
3.	First class brick work in 1:6 cement sand mortar (1 cement and 6 fine and coarse sand) in foundations as shown in the drawing upto plinth level including cost of material and labour and T&P etc. required the work, Including cost of curing by water for required period.	22.00	Cu.M.
4.	Laying D.P.C. over foundation brick work, 2.5 cm (1”) thick cement concrete (1 cement, 1.5 coarse sand and 3 graded stone grit) mixed with required water proofing compound as shown in the drawing, including cost of material and labour and T&P etc. required for the work, curing with water shall also be done.	9.00	Sq.M.
5.	First class brick work in super-structure in 1:4 cement sand mortar (1 cement and 4 coarse sand) including cutting and moulding of bricks as required and also making a slit as shown in the drawing and placement of reinforcement steel bars	16.00	Cu.M.

	in position as shown in the drawing including cost of material and labour and T&P etc. as required the work, Including cost of curing by water for 28 days.		
6.	Supplying and laying mild steel deformed bars of diameter as shown in the drawing including its straightening, over lapping at joints and bending and binding, including wastage and cost of material and labour and T&P required for the work.	105.00	Kg
7.	12 m.m. thick plaster in 1:6 cement sand mortar (1 cement and 6 fine and coarse sand) including wastage and cost of material and labour and T&P required for the work, Including cost of curing by water for 28 days.	244.00	Sq.M.
8.	Applying Birla Putty over newly plastered and dried wall and making it smooth by sand paper and painting two coats of specified exterior paint of colour as directed at site, the second coat be applied when first coat has dried up, including cost of material and labour and T&P etc. required for proper completion of work.	244.00	Sq.M.
9.	Filling sand/earth upto the level of plinth including its cartage, watering, ramming and dressing of surface at plinth level giving shape of a flat ground at plinth level, including cost of material and labour and T&P required for the work.	211.00	Sq.M.
10.	Dismantling old boundary wall as shown in the drawing, its brick work and plaster etc. and stacking the materials within 60 M. at the places as directed at site.	4.20	Cu.M.

**Notes :**

(1) 9" thick Lintal shall be laid over the nala on both sides, over which boundary wall shall be constructed to join with the old boundary wall, for which no extra payment shall be made.

(2) Old bricks takenout form old boundary wall after dismantling can be used in the work after proper cleaning for which no deduction shall be made.

## **SPECIFICATION FOR EXTERIOR PAINT AND OIL PAINT**

1. **Exterior Paint :** Exterior paint of either of the following quality shall be used :-

- a. Asian Paints ..... Apex
- b. Berger Paints ..... Weather Coat
- c. Narolac Paints ..... Excel anti peel

The colour as directed shall be prepared by the colour bank using computer to avoid any variation in colour.

2. **Putty :** Only Birla Putty shall be used.

3. **Paint and Primer :**

- a. Berger primer premix paint shall be used.
- b. Luxol Hi-Gloss Enamel Paint of Berger make shall be used, black colour on iron works and pale cream on wood work shall be used.

## **SPECIAL CONDITIONS**

1. All Documents including drawings are to be signed by the tenderer failing which the tender shall be rejected without giving any reason.
2. Tenderer can be asked to submit their analysis of rates for justifying their quoted rates.
3. Rates quoted by the tenderer, if found unworkable, the tender shall be rejected without giving any reason.
4. Tender for constructing Boundary Wall, Painting and Repairs can be separately accepted without giving any reason.
5. Earnest Money of Rs. 20000 in form of Bank draft required to deposited with tender.
6. Tender cost Rs, 100 also be required to be deposited with the tender in form of separate bank draft if this tender is downloaded online, otherwise tender can be obtained from Bharat Seva Sansthan, Moti Mahal, 2 Rana Pratap Marg, Lucknow – 226001 after paying Rs. 100/-
7. Details of Income Tax return/Pan Number/Contractor Registration certificate/past experience certificate may also be attached with tender.
8. Last date fo submission of tender is 25/11/2016.
9. Tender will be opened on the next day that is 26/11/2016 at 16:00 hours.

# DRAWING OF BOUNDARY WALL

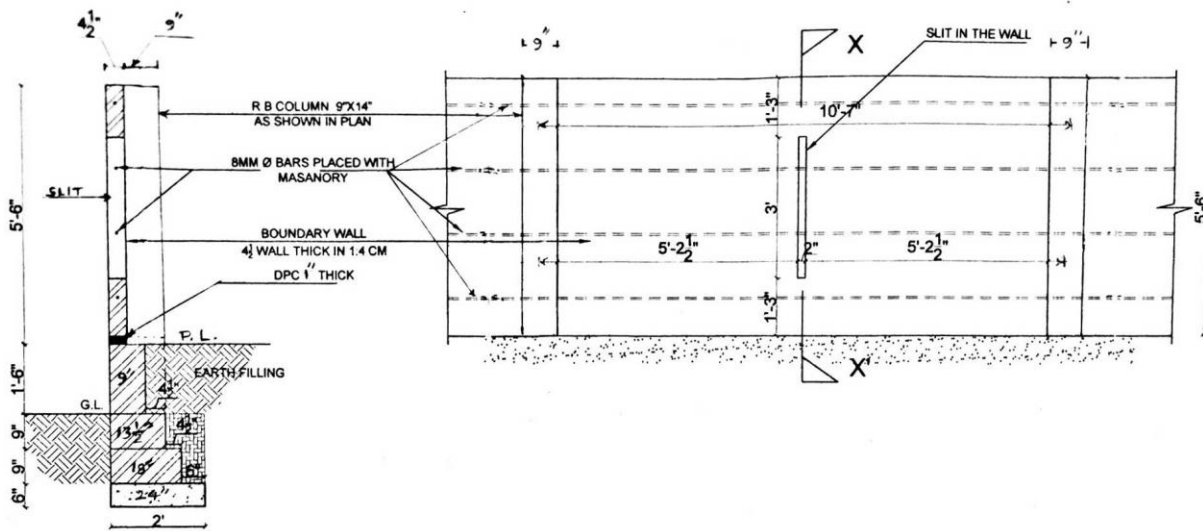

CASE  
BHARAT SEWA SANSTHAN

PROPOSED  
BOUNDARY WALL

BOUNDARY LAYOUT,  
SECTION AND ELEVATION

ARCHITECT  
PULKIT YADAV

*Pulkit Yadav*  
(A. PULKIT YADAV)  
B.Arch  
CA/2014/62677  
E-11/110 Vishal Khand  
Gomtinagar, Lu

8 APR 24  
PH-0440-686-077  
9880-640-664  
E-mail: pulkit@pulkityadav.com

Scale  
Date  
Sheet  
SEC. NO.

# DRAWING OF BOUNDARY WALL

